



ETd 01

Battery Powered Digital Pressure Gauge

Ceramic Sensor

class 0.5

Nominal pressure

from 0 ... 1.6 bar up to 0 ... 250 bar

Special characteristics

- ▶ rotatable housing and display
- ▶ LC display
4.5-digit 7-segment display
- ▶ standard battery CR 2450
operation period > 1.800 h

Functions

- ▶ min / max function with reset function
- ▶ auto-zero
- ▶ setting of pressure unit
(bar, mbar, psi, MPa, mH₂O)
- ▶ automatic switch-off configuration

The compact low-cost digital pressure gauge ETd 01 is battery-powered and has an adjustable housing; it is thus extremely suitable for mobile pressure monitoring. The 4.5-digit LC-display indicates the battery status, the measurement value as well as the unit, this enables a fast and precise reading.

It is possible to switch between the most common units (bar, psi, Pa, MPa). Additional functions as auto-zero, min / max values and an automatic switching-off complete the Etd 01 profile.

Preferred areas of use are



Mobile Pressure Monitoring
Plant and Machine Engineering
Pneumatics / Hydraulics



Environmental Engineering
(water – sewage – recycling)



Input Pressure													
Nominal pressure gauge	[bar]	1.6	2.5	4	6	10	16	25	40	60	100	160	250
Overpressure	[bar]	4	4	10	10	20	40	40	100	100	200	400	400
Burst pressure	[bar]	7	7	15	15	35	70	70	150	150	250	450	450
Vacuum resistance		unlimited											

Performance			
Accuracy ¹	≤ ± 0.5 % FSO BFSL		
Measuring rate	1/sec		
Long term stability	≤ ± 0.3 % FSO / year		
¹ accuracy according to IEC 60770 – minimum value setting (non-linearity, hysteresis, repeatability)			
Thermal effects (Offset and Span)			
Tolerance band	≤ ± 0.5 % FSO / 10 K (typ.)		in compensated range 0 ... 50 °C
Permissible temperatures			
Permissible temperatures	medium: -25 ... 85 °C	environment: 0 ... 70 °C	storage: 0 ... 70 °C
Materials			
Pressure port / housing	stainless steel 1.4301 (304)		
Display housing	PA 6.6, Polycarbonate		
Seals (media wetted)	FKM	others on request	
Diaphragm	ceramics Al ₂ O ₃ 96 %		
Media wetted parts	pressure port, seals, diaphragm		
Miscellaneous			
Display	LC-Display, visible range 36 x 15 mm; 4.5-digit 7-segment-display, digit size 8.5 mm, range of indication ±1999		
Electromagnetic compatibility	emission and immunity according to EN 61326		
Supply	3 V lithium battery (CR 2450)		
Data storage	EEPROM (non-volatile)		
Ingress protection	IP 65		
Installation position	any		
Weight	plastic: approx. 150 g		
Operational life of battery	min. 1500 h with permanent operation		
Mech. operational life	> 100 x 10 ⁶ pressure cycles		
CE-conformity	EMC directive 2004/108/EC		pressure equipment directive: 97/23/EC (Modul A) ²

²This directive is only valid for devices with maximum permissible overpressure > 200 bar.

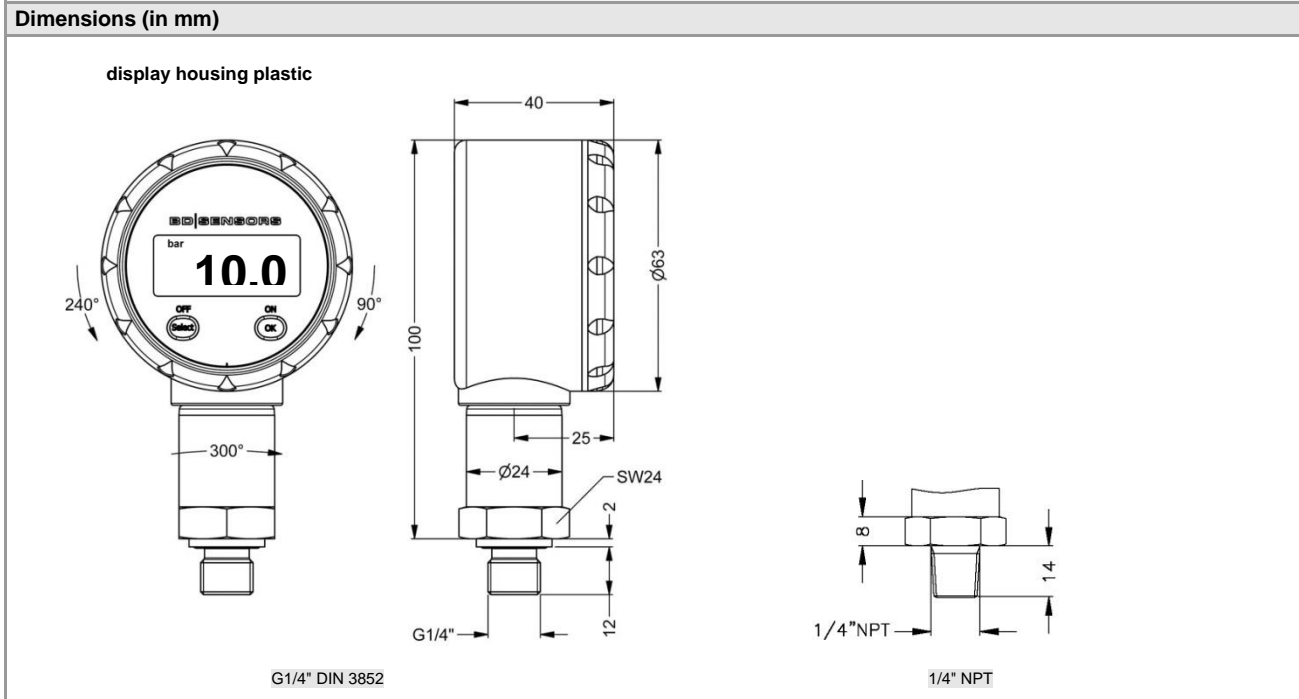

The specifications given in this document represent the state of engineering at the time of publishing. We reserve the right to make modifications to the specifications and materials.